

欧标40槽宽8.2系列铝合金型材

◀ 边长40/80mm

代码	材质	表面处理
AOB03	A6063-T5	黑色氧化
AOB05		喷砂氧化

- ① 切断面未进行氧化处理。
- ② 最大使用长度：5800~5850mm；
整条标准长度：6000~6020mm。

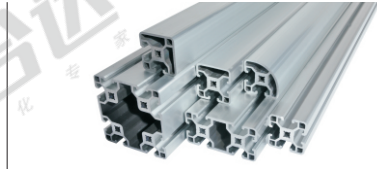

◻ L长度公差

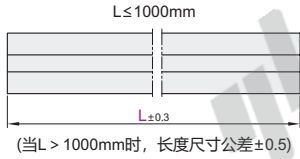

◻ 槽口详图

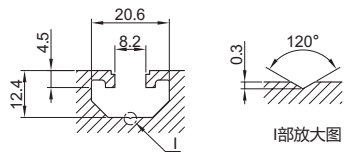
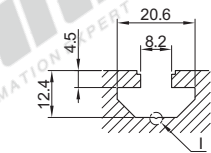

AOB05-4040

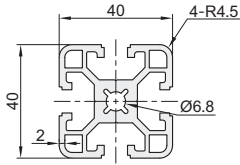

AOB05-4040C

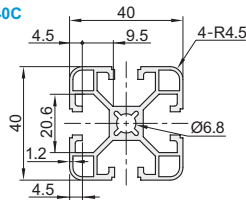

AOB03-4040E
AOB05-4040E

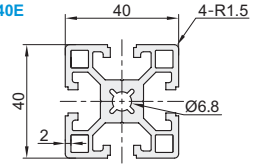

AOB05-4040F

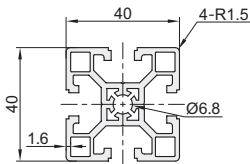

AOB03-4040J
AOB05-4040J

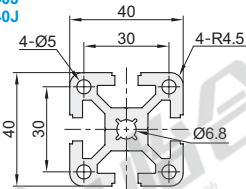

AOB05-4040A

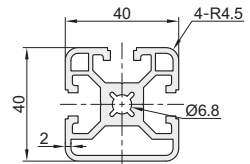

AOB05-4040B

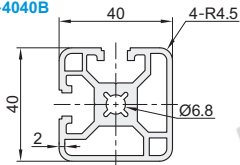

AOB05-4040H

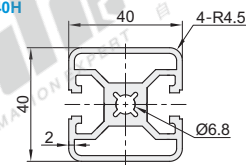

AOB05-4040T

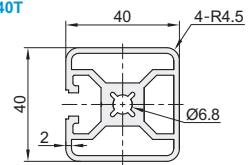

AOB05-4040R

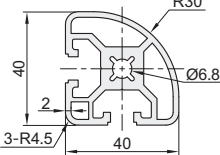

AOB03-4040RE
AOB05-4040RE

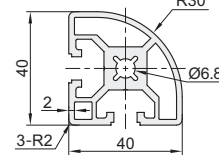

AOB05-4040XE

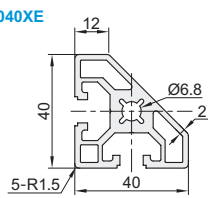

AOB05-4430

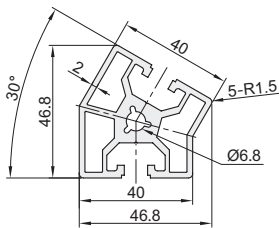

AOB05-4445

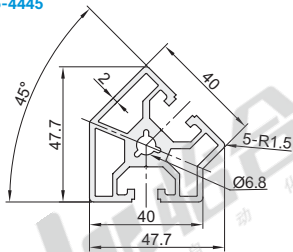

AOB05-4460

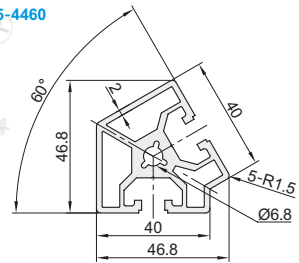

AOB05-4040HC
折叠门型材

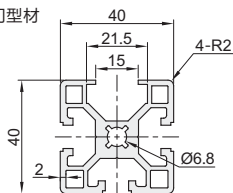

AOB05-4080

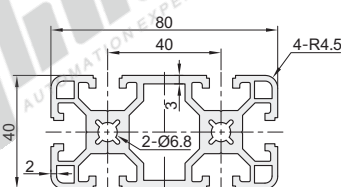

AOB05-4080C

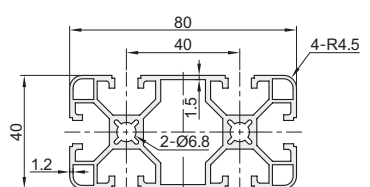

槽宽8.2系列
欧标40

AOB03-4080E
AOB05-4080E

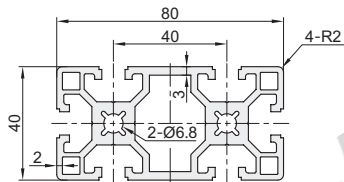

AOB05-4080F

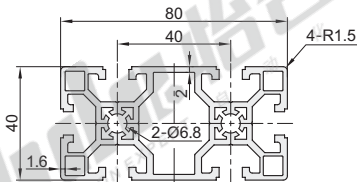

AOB03-4080J
AOB05-4080J

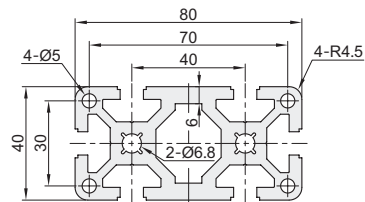

AOB05-4080A

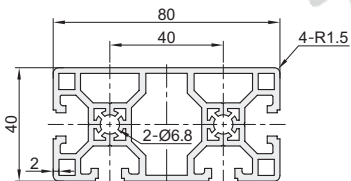

AOB05-4080FA

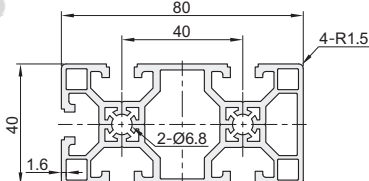

AOB05-4080B

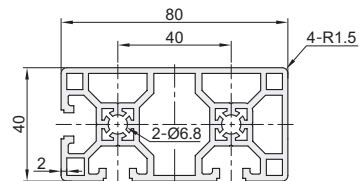

AOB05-4080H

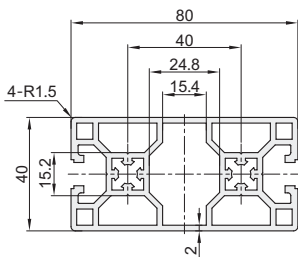

AOB05-8840

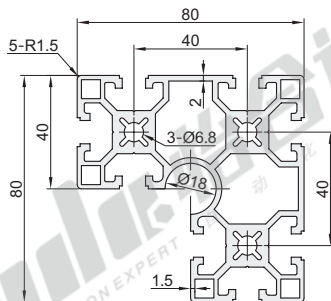

AOB05-8840R

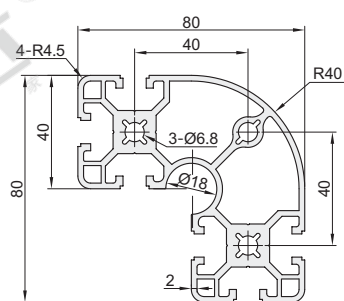

AOB05-8840RE

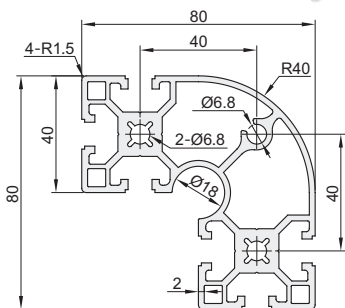

AOB05-8840RF

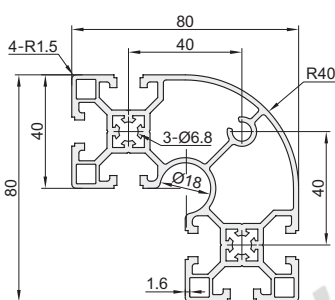

AOB03-8080E
AOB05-8080E

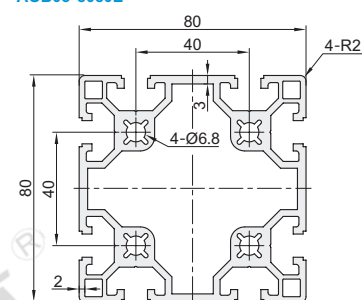

AOB05-8080

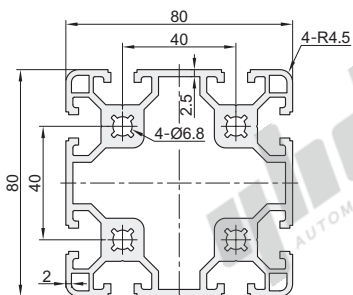

AOB05-8080A

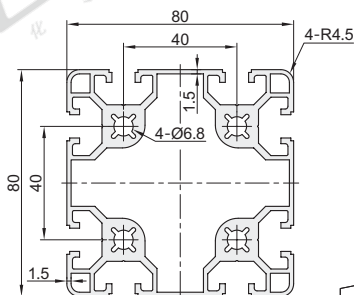

欧标40槽宽8.2系列铝合金型材

◀ 边长80/120/160/200mm

AOB05-8080F

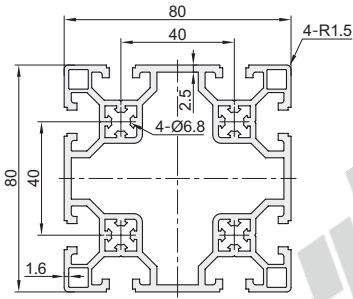

AOB05-8080FA

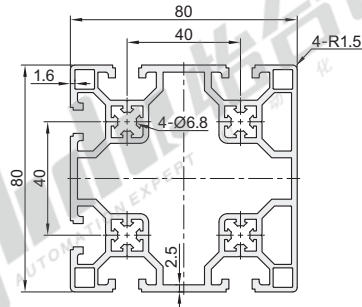

AOB05-8080J

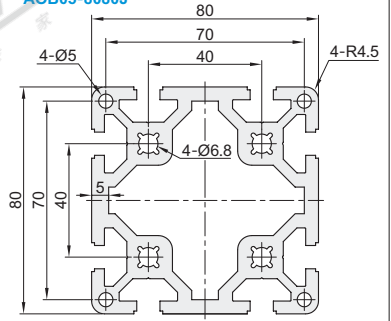

AOB05-8080XE

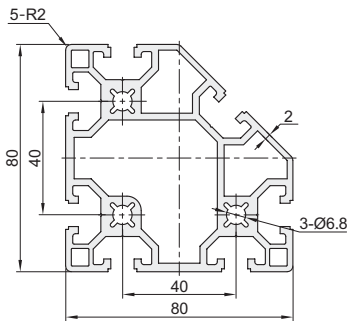

AOB05-40120E

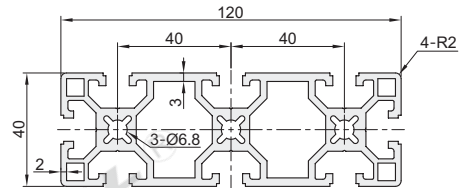

AOB05-40160E

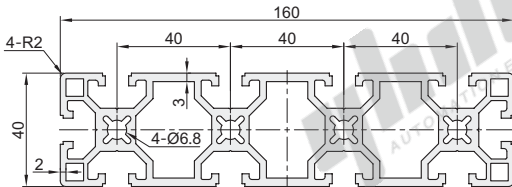

AOB05-80160E

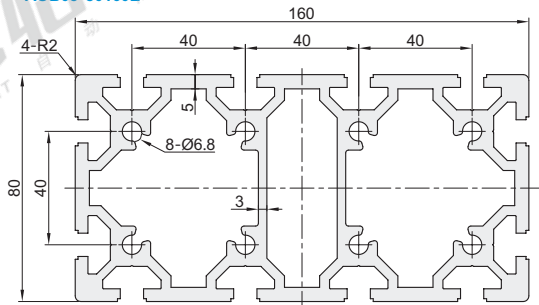

AOB05-40200E

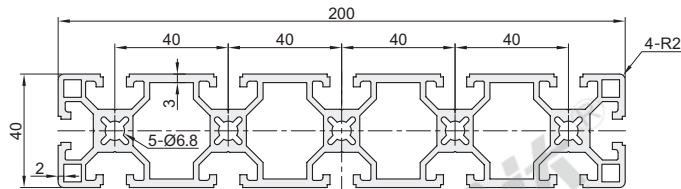

AOB05-80200E

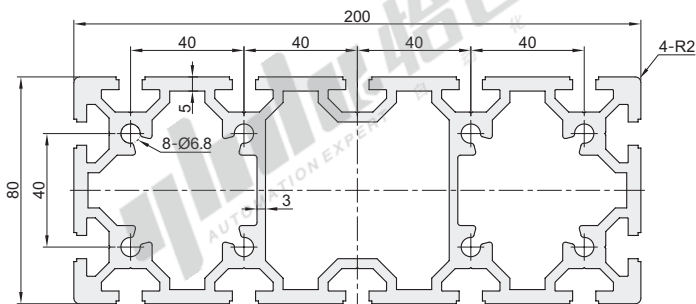

AOB05-80120E

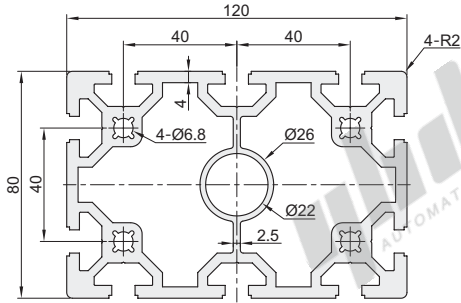

AOB05-120120E

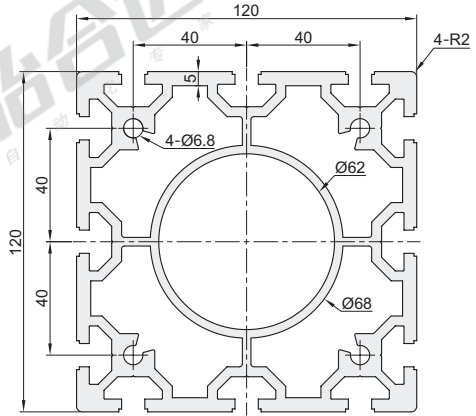

AOB05-120120G

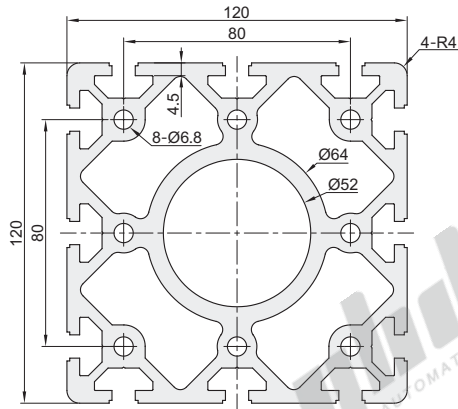

AOB05-160160E

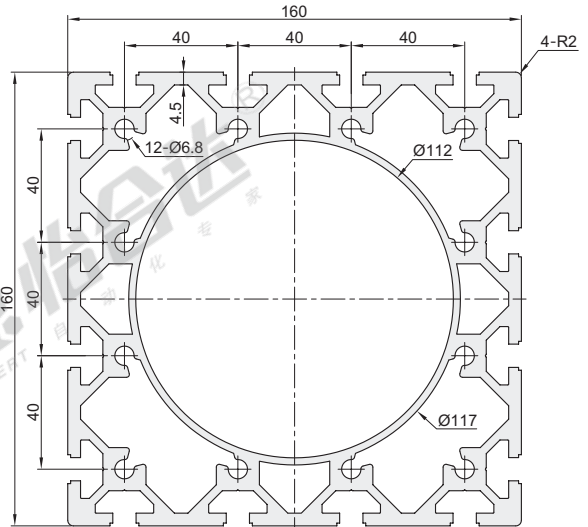

AOB05-200200E

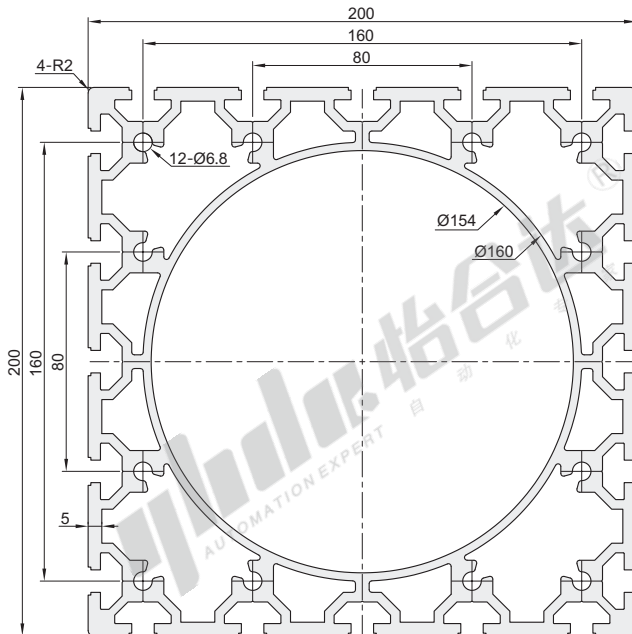

欧标40槽宽8.2系列铝合金型材

型号 代码	规格	L 最小单位0.5	截面尺寸	每米重量Kg/m (理论值)	截面积 (mm ²)	截面惯性矩		抗弯截面模数	
						α	γ	Wxmax (mm ³)	Wymax (mm ³)
AOB03	4040E		40×40	1.72	608.10	9.22×10 ⁴	9.22×10 ⁴	4609.80	4609.80
	4040J			2.12	747.69	11.47×10 ⁴	11.47×10 ⁴	5733.10	5733.10
	4040RE			1.54	543.40	7.24×10 ⁴	7.24×10 ⁴	3360.99	3360.99
	4080E		40×80	3.10	1094.38	17.79×10 ⁴	66.91×10 ⁴	8893.20	16727.53
	4080J			4.13	1457.63	23.85×10 ⁴	83.36×10 ⁴	11922.55	20838.83
	8080E		80×80	4.66	1642.72	119.09×10 ⁴	119.09×10 ⁴	29771.48	29771.48
	4040		40×40	1.69	597.70	8.82×10 ⁴	8.82×10 ⁴	4411.05	4411.05
	4040C			1.23	432.73	6.67×10 ⁴	6.67×10 ⁴	3333.30	3333.30
	4040E			1.72	608.10	9.22×10 ⁴	9.22×10 ⁴	4609.80	4609.80
	4040F			1.50	535.91	8.28×10 ⁴	8.28×10 ⁴	4139.80	4139.80
4040J		2.12		747.69	11.47×10 ⁴	11.47×10 ⁴	5733.10	5733.10	
4040A		1.67		588.53	8.70×10 ⁴	8.70×10 ⁴	4305.22	4349.35	
4040B		1.69		596.60	8.87×10 ⁴	8.87×10 ⁴	4395.26	4395.26	
4040H		1.64		579.36	8.58×10 ⁴	8.58×10 ⁴	4288.16	4288.16	
4040T		1.65		581.18	8.52×10 ⁴	8.76×10 ⁴	4261.69	4380.41	
4430		1.71		604.06	8.70×10 ⁴	9.17×10 ⁴	3233.92	3492.17	
4445		1.71	603.12	8.75×10 ⁴	9.14×10 ⁴	3126.54	3406.69		
4460		1.71	604.57	8.83×10 ⁴	9.14×10 ⁴	3239.80	3527.88		
4040R		1.54	544.45	7.14×10 ⁴	7.14×10 ⁴	3323.41	3320.92		
4040RE		1.54	543.40	7.24×10 ⁴	7.24×10 ⁴	3360.99	3360.99		
4040XE		1.45	512.62	6.41×10 ⁴	6.41×10 ⁴	2832.74	2832.74		
4080		3.08	1085.80	17.45×10 ⁴	65.52×10 ⁴	8722.75	16380.50		
4080C		2.16	760.52	12.80×10 ⁴	47.98×10 ⁴	6399.25	11993.75		
4080E		3.10	1094.38	17.79×10 ⁴	66.91×10 ⁴	8893.20	16727.53		
4080F		2.72	959.18	15.94×10 ⁴	59.55×10 ⁴	7970.60	14887.15		
4080J		4.13	1457.63	23.85×10 ⁴	83.36×10 ⁴	11922.55	20838.83		
4080A		2.78	980.91	17.84×10 ⁴	66.00×10 ⁴	8898.28	16500.98		
4080FA		2.61	960.95	15.89×10 ⁴	60.08×10 ⁴	7944.73	15019.74		
4080B		2.79	982.65	17.44×10 ⁴	62.72×10 ⁴	8597.83	15307.57		
4080H		2.85	984.38	17.65×10 ⁴	65.837×10 ⁴	4412.75	32918.50		
8840		4.12	1453.23	82.20×10 ⁴	82.20×10 ⁴	17810.51	17810.51		
8840R		3.61	1273.25	72.07×10 ⁴	72.07×10 ⁴	16722.25	16722.25		
8840RE		3.67	1298.44	74.69×10 ⁴	74.69×10 ⁴	17466.95	17466.95		
8840RF		3.19	1126.28	65.85×10 ⁴	66.08×10 ⁴	15397.37	15452.46		
8080		4.90	1727.15	119.20×10 ⁴	119.19×10 ⁴	29799.03	29798.58		
8080A		4.20	1482.51	102.13×10 ⁴	102.13×10 ⁴	25532.05	25532.05		
8080E		4.66	1642.72	119.09×10 ⁴	119.09×10 ⁴	29771.48	29771.48		
8080F		4.29	1511.46	108.20×10 ⁴	108.19×10 ⁴	27047.68	27047.68		
8080FA		4.07	1507.71	108.21×10 ⁴	108.21×10 ⁴	27053.94	27053.23		
8080J		6.54	2306.57	159.74×10 ⁴	159.98×10 ⁴	39934.13	39934.13		
8080XE		4.31	1520.24	94.14×10 ⁴	94.14×10 ⁴	21222.00	21222.00		
40120E		4.28	1508.71	26.43×10 ⁴	225.65×10 ⁴	13216.55	37608.70		
40160E		5.57	1965.01	34.90×10 ⁴	467.82×10 ⁴	17451.65	58477.78		
40200E		6.56	2312.88	42.35×10 ⁴	863.63×10 ⁴	21173.95	86363.44		
80120E		8.12	2863.59	223.44×10 ⁴	467.28×10 ⁴	55859.83	77880.10		
80160E		10.60	3739.33	303.04×10 ⁴	1004.90×10 ⁴	75759.18	125611.98		
80200E		12.44	4389.65	396.23×10 ⁴	1877.10×10 ⁴	92306.33	187710.33		
120120E		11.37	4011.31	677.34×10 ⁴	677.34×10 ⁴	112889.20	112889.20		
120120G		14.67	5174.84	762.41×10 ⁴	762.41×10 ⁴	127068.48	127068.48		
160160E		16.57	5846.12	1870.81×10 ⁴	1870.81×10 ⁴	233851.01	233851.01		
200200E		21.32	7896.30	4058.42×10 ⁴	4058.42×10 ⁴	405842.00	405842.00		
4040HC		1.59	559.13	7.99×10 ⁴	9.03×10 ⁴	3759.16	4516.35		

槽宽8.2系列
欧标40



请按图示订货

型号		L	截面尺寸
代码	规格	最小单位0.5	
AOB03	4040E	50000	40×40
	4040RE		

AOB03—4040E—L550

可选加工

型号		L	可选加工代码
代码	规格	最小单位0.5	
AOB03	4040E	50000	LM RM DM
	4040RE		

AOB03—4040E—L550—RM



可选加工

端面螺孔加工

代码	技术说明
	变更通孔为螺孔
	选型方法 LM/RM/DM
	① Ø6.8通孔变更为螺孔M8深20。
	② 可选加工见P571~576。

